

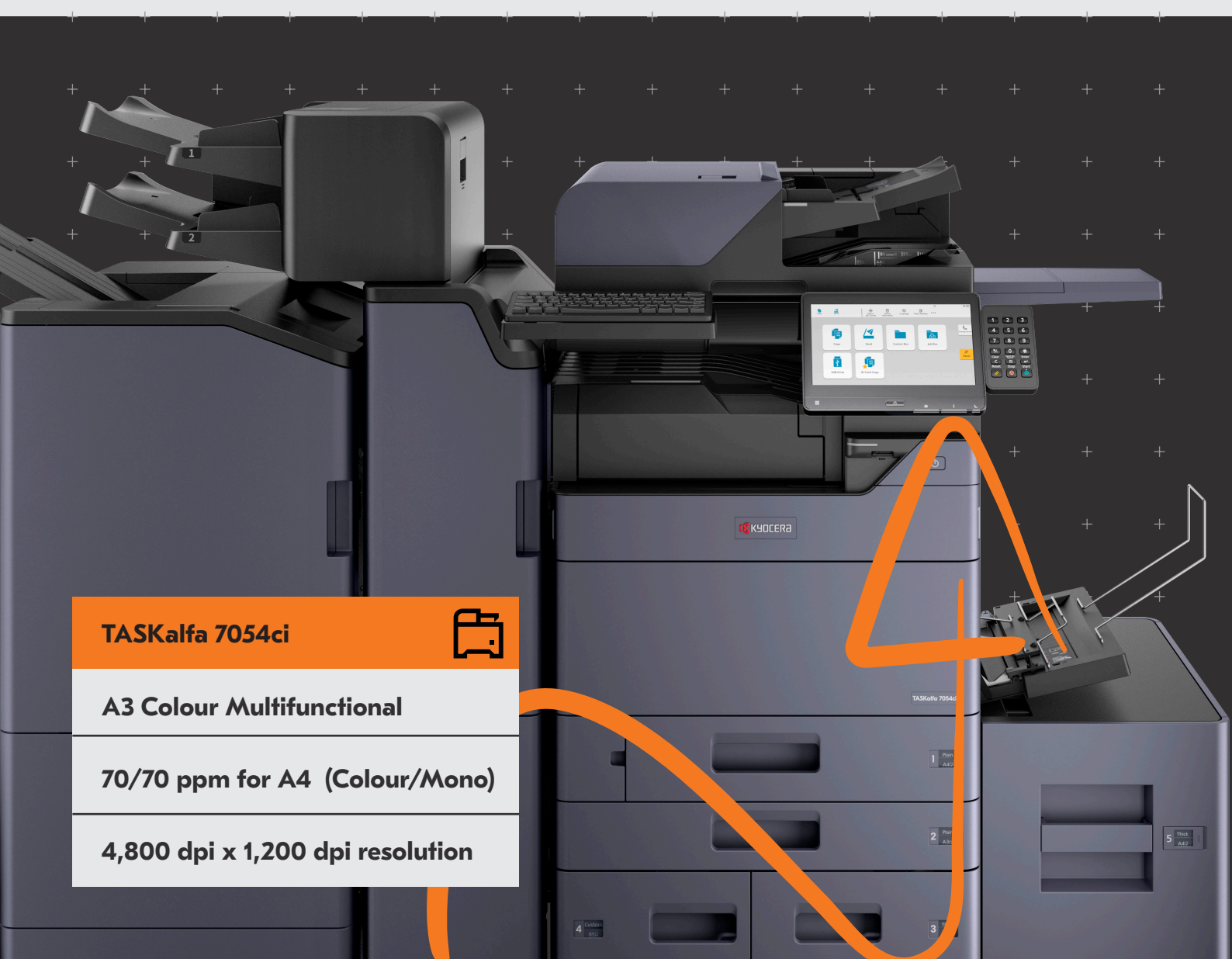

Designed to grow your business securely in an ever changing business landscape

The TASKalfa 7054ci prints perfect, stable, quality images every time in black and white or colour thanks to the newly developed toner. Focus on what matters most, and securely, with this device's latest intelligent security features.



TASKalfa 7054ci



A3 Colour Multifunctional

70/70 ppm for A4 (Colour/Mono)

4,800 dpi x 1,200 dpi resolution

Specifications

GENERAL

KYOCERA TASKalfa Laser Colour Multifunctional, HyPAS™ solution platform
Operation panel: 256.5 mm (10.1 inch) full-colour touch panel display, speaker for job notification, 15° - 90° swivel mounted
Engine speed: Up to 70/35 pages A4/A3 per minute, Duplex print/copy speed: 70 pages A4 per minute
Resolution: 4800dpi equivalent x 1200dpi (print) 600 dpi x 600dpi (scan/copy)
Warm-up time: 26 seconds or less
Time to first print: 3.7/5.0 seconds or less in Mono/Colour
Time to first copy: 4.1/6.2 seconds or less in Mono/Colour (DP), approx. 3.4/4.4 or less in Mono/Colour (Platen)
CPU: ARM A53 (Quad Core) 1.6GHz
Memory: Standard 4GB +64GB SSD, Optional 320GB or 1TB HDD
Standard interfaces: USB 3.0 (Super-Speed USB), 4 x USB Host Interface, Gigabit Ethernet (10BaseT/100BaseTX/1000BaseT, IPv6, IPv4, IPSec, 802.3az support), optional Wi-Fi (IEEE 802.11a/b/g/n/ac), 2 eKUIO slots for optional internal print server or for optional fax system, slot for optional Wireless LAN, Slot for optional SD Card, NFC tag
Dimensions (W x D x H): 602mm x 665mm x 790 mm
Weight: Approx. 95kg
Power source: AC 220–240 V, 50/60 Hz
Power consumption: Print Mode: 1140 W; Copy Mode: 1140 W; Ready Mode: 45 W; Lower Mode: 40 W Sleep Mode: 0.5 W
Noise (surface sound pressure level: ISO 7779 measurement distance of 1 meter)
 Copying/Printing Mode in Colour: 74 dB(A) L_{PA}
 Stand-by: 35dB(A)
Safety standards: TÜV/GS, CE. This unit is manufactured according to ISO 9001 quality standard and ISO 14001 environmental standard.

PAPER HANDLING

All paper capacities quoted are based on paper thickness of max. 0.11 mm. Please use paper recommended by Kyocera under normal environmental conditions.
Input capacity: Multi-purpose tray: 150 sheets, 52 - 300g/m² (Banner 136–163 g/m²), A6R - SRA3 (320 x 450 mm), Banner max. 304.8 x 1,220 mm, Standard universal paper cassette: 2 x 500 sheet 52 - 300g/m², Upper cassette A6R up to A4R, lower cassette A6R up to SRA3, Max. input capacity with options: 7,150 sheets A4
Duplex: Standard supports 60–256g/m², SRA3 to A6R
Output capacity: Standard 500 sheets face down, max. 5,000 sheets

PRINT FUNCTIONS

Controller language: PRESCRIBE
Emulations: PCL6 (PCL5c / PCL-XL), KPDL3 (PostScript 3 compatible), PDF Direct Print, XPS Direct Print and OpenXPS
Operating systems: All current Windows operating systems, Chrome OS, MAC OS X Version 10.9 or higher, Unix, Linux as well as other operating systems on request
Fonts/barcodes: 93 outline fonts (PCL), 136 fonts (KPDL 3), 4 fonts (Calibri), 4 fonts (Cambria), 1 Bitmap font, 45 types of one-dimensional barcodes, 1 type of two-dimensional barcode (PDF417)
Print features: Encrypted PDF 2.0 Direct Print, IPP printing, e-mail printing, WSD print, secure printing via SSL, IPsec, SNMPv3,

quick copy, proof and hold, private print, job storage and job management functionality, Super Resolution
Mobile printing support: AirPrint, Mopria, NFC, Direct Wi-Fi (optional), MyPanel and KYOCERA Mobile Print app for iOS and Android, Microsoft Cloud printing

COPY FUNCTIONS

Max. original size: A3/Ledger
Continuous copying: 1–9,999
Zoom range: 25–400% in 1% steps
Preset magnification ratios: 5 Reductions/5 Enlargements
Exposure mode: Manual: 17 steps
Image adjustments: Text + Photo, Photo, Text, Diagram/Map
Features: Scan-once-copy-many, electronic sort, 2in1, 4in1, image repeat, page numbering, cover mode, booklet copy, interrupt copy, form overlay, margin shift, auto cassette change, skip blank page, ID copy, Handwriting erase and highlight

SCAN FUNCTIONS

Functionality: Scan-to-email, Scan-to-FTP, Scan-to-SMB 3.0, Scan-to-USB Host, Scan-to-box, Network TWAIN, WSD scan (WIA Driver Network), DFS Scan, DSM Scan
Scan speed: 274 ipm (300 dpi, A4, duplex, with DP-7160/7170)
Scan resolution: 600, 400, 300, 200 dpi, 256 greyscales per colour (1,200 dpi via TWAIN and WIA driver only)
Max. scan size: A3, Ledger
Original recognition: Text, photo, text + photo, Light Text / Fine Line, optimised for OCR
File types: TIFF, PDF, PDF/A, JPEG, Open XPS, Encrypted PDF, High compression PDF, PDF/A-1a/b, PDF/A-2a/b/u, Searchable PDF(Optional), MS Office file(Optional)

FAX FUNCTIONS (OPTIONAL)

Compatibility: ITU-T Super G3
Modem speed: Max. 33.6 kbps
Transmission time: Less than 3 seconds (IBIG)
Scanning speed: 2.0 seconds or less
Maximum original size: A3/Ledger, Banner: 1,600mm
Compression method: JBIG, MMR, MR, MH
Features: Network faxing, rotate transmission, rotate reception, encrypted transmission and reception, duplex fax reception, memory reception, mailbox, remote diagnostics, polling transmission and reception, broadcast, Optional Internet-fax, dual fax with second fax system 12

CONSUMABLES

Average continuous toner yield in accordance with 5% coverage A4
TK-8559K Toner Kit: Microfine toner black for 40,000 pages A4
TK-8559C, TK-8559M, TK-8559Y Toner Kits: Microfine toner cyan, magenta, yellow for 24,000 pages A4
Staples: SH-10: 5,000 x 3 staples for BF-730, DF-7120, BF-9100, SH-12: 5,000 x 3 staples for DF-7140, SH-14: 5,000 x 5 staples for DF-7150
WT-8500: Waste Toner Bottle: 40,000 sheets (in accordance with 5% coverage, b/w : colour = 7:3)

OPTIONS

Fax System 12
Internet Fax Kit (A) AC

Scan Extension Kit (A) AC: Scan to searchable PDF solution (embedded OCR), convert to PDF or MS Office (docx, xlsx, pptx)
Printing System 17: Fiery Controller
Printing System Interface Kit 15B: Interface board for Fiery
DP-7150: Document Processor (Reversing), 140 sheets, 35–160 g/m² (simplex), 50–120 g/m² (duplex), A6R–A3, Banner up to 1,900 mm
DP-7160: Document Processor (one-path duplex scanning), 320 sheets at 50 - 80 g/m², 35–220 g/m² (simplex), 50–220 g/m² (duplex), A6R–A3, Banner up to 1,900 mm
DP-7170: Document Processor (one-path duplex scanning with ultrasonic sensor), 320 sheets at 50 - 80 g/m², 35–220 g/m² (simplex), 50–220 g/m² (duplex), A6R–A3, Banner up to 1,900mm
DT-730(B): Document tray
PF-7120: Side Deck: 3,000 sheets, A4, 60–300 g/m²
PF-7140 Paper feeder: 2 x 500 sheets, 52–300 g/m², A6R–SRA3
PF-7150 Paper feeder: 2 x 1,500 sheets, A4, 52–300 g/m², A4, B5, Letter
DF-7120* Document finisher + AK-7110: 1,000 sheets A4, 52–300 g/m², A6R–SRA3, Stapling up to 50 sheets A4 or 30 sheets A3 at 3 positions
DF-7140* Document finisher + AK-7110: Main tray: 4,000 sheets A4, Sub tray: 200 sheets A4, 52–300 g/m², A6R–SRA3, Stapling up to 65 sheets A4 or 30 sheets A3 at 3 positions
DF-7150* Document finisher + AK-7110: Main tray: 4,000 sheets A4, Sub tray: 200 sheets A4, 52–300 g/m², A6R–SRA3, Stapling up to 100 sheets A4 or 50 sheets A3 at 3 positions
AK-7110: Attachment kit for DF-7120, DF-7140 and DF-7150
 100 sheets, 52–300 g/m², A6R–SRA3
 * Bridge unit AK-7110 is required when using a finisher
ZF-7100: Z-folding, Bi-folding, Inner and Outer tri-folding
IS-7100: Inserter, Cover and Backing sheet insertion, 52–300 g/m², A6R–SRA3
AK-7120: Attachment kit for Z-folding unit
PH-7C: Punch unit for DF-7120, DF-7140 and DF-7150
 2-hole/4-hole, 52–300 g/m², A5R–A3
MT-730(B): Mailbox sorter for DF-7140
 7 bins x 100 sheets A4, 50 sheets A3/B4, 60–163 g/m²
BF-730: Booklet and tri-folding unit for DF-7140
BF-9100: Booklet and tri-folding unit for DF-7150
JS-7100: 100-sheet internal job separator, 52–300 g/m², A6R–SRA3
JS-7110: 250-sheet Inner shift tray, 52–300 g/m², A6R–SRA3
Banner Guide 10: Banner paper feeding guide, 10 sheets
HD-15: HDD 320 GB
HD-16: HDD 1 TB
NK-7120: Numeric keypad
Keyboard Holder 10
UG-33 AC: ThinPrint support
UG-34 AC: Emulation (IBM Proprinter/EPSON LQ-850 LinePrinter)
USB IC Card Reader + Card Authentication Kit (B) AC
IB-37: Wireless Network Interface (USB : 5GHz/2.4GHz)
IB-50: GB-Ethernet board 10 BaseT/100 BaseTX/1,000 BaseT
IB-51: Wireless LAN Interface (802.11b/g/n)
Platen cover Type (E)
1290/30: Cabinet

The TASKalfa 7054ci incorporates extremely durable components that guarantee efficient and reliable operation to meet the demanding requirements of busy office environments. The TASKalfa 7054ci provides effective productivity and maximum flexibility, whilst ensuring minimum impact on the environment.

HyPAS



digital
document
solutions

Phone: 08 9328 4600
 Email: dds@multifaxdds.com.au
 Web: www.multifaxdds.com.au

